

resistant materials require minimum care.

If used in salt water, be sure to remove the spool and rinse your reel thoroughly in warm fresh water. Then, wipe dry. Do not apply water under pressure, since this simply forces salt water particles into your reel's mechanism. When used in salt water we suggest spraying the metal parts of your reel, after each trip, with a moisture absorbent spray such as WD-40.

Always remove any sand particles from your reel. Should you accidentally drop your reel in sand or gravel, it may be necessary to disassemble and thoroughly clean all parts before further use. The push button spool removal system on your reel makes this job easy. Apply a high-grade lubricant, such as South Bend "Super Reel Oil" (with Teflon), on all of your moving parts (with the exception of the disc drag system). At least once a year, remove the spool and grease the main shaft with South Bend "Super Reel Grease", which is especially formulated for fresh and salt water reels.

### LIMITED WARRANTY

Crystal River will repair or replace any product which proves defective in workmanship or materials within ninety days from the date of original purchase.

This warranty does not cover damage caused by negligence, accident, misuse, alteration of the product, or normal expected wear. Damage that is determined to be of this nature will be repaired at customer's expense.

**IMPORTANT**—Specify reel model number when ordering parts.  
**Example**—Extra spool for Crystal River Royal Coachman Rim Fly Reel CR-2101—specify CR-2101 (reel no.) - 11 (spool part no.)

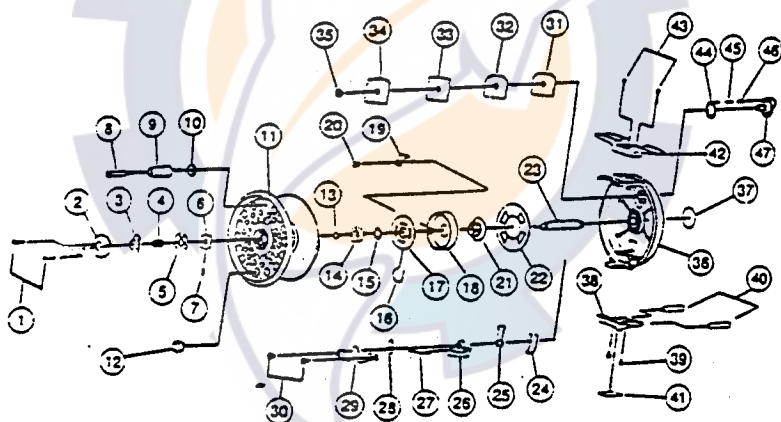

KEY NO.	DESCRIPTION	KEY NO.	DESCRIPTION
1	P/BUTTON COVER SCREW	25	S/P LOCK PLATE
2	PUSH BUTTON COVER	26	CLICK PAWL S/P
3	PUSH BUTTON	27	CLICK PAWL
4	P/BUTTON SPRING	28	C/PAWL COVER
5	LOCK PLATE COVER	29	C/PAWL COVER S/C
6	SPOOL LOCK PLATE	30	DRAG W/S "A"
7	LOCK PLATE SPRING	31	DRAG W/S "B"
8	HANDLE RIVET	32	DRAG W/S "C"
9	HANDLE KNOB	33	DRAG W/S "D"
10	H/KNOB COLLAR	34	"E" - CLIP
11	SPOOL UNIT	35	FRAME UNIT
12	BALANCE WEIGHT(ONLY AXLE II)	36	FRAME LABEL
13	"O" - RING	37	LINE GUIDE
14	SPOOL BUSH(AXLE II - BALL BEARING)	38	L/GUIDE S/C
15	ADJUST W/S	39	LINE ROLLER
16	SILENT CAM	40	L/GUIDE LABEL
17	RATCHET	41	STAND
18	STOPPER COVER	42	STAND SCREW
19	STOPPER	43	D/KNOB RETAINER
20	STOPPER RIVET	44	DRAG STOPPER
21	RATCHET COVER	45	D/STOPPER S/P
22	DRAG DISK	46	DRAG KNOB
23	MAIN SHAFT	47	
24			